

# GROUP 1



NGUYEN KHANH LY



VAN CONG HIEN



TRAN THI PHUONG



KOKI HIROSAWA



DANG CONG QUOC HUY



MOEKA TANISHHITA



PHAM DINH QUAN



# HAI CHAU COMMUNAL HOUSE

PHAN CHAU TRINH ST, HAI CHAU  
DISTRICT, DA NANG CITY, VIETNAM

*HISTORY, TRADITIONAL, CULTURAL VALUE  
IN MODERN LIFE*



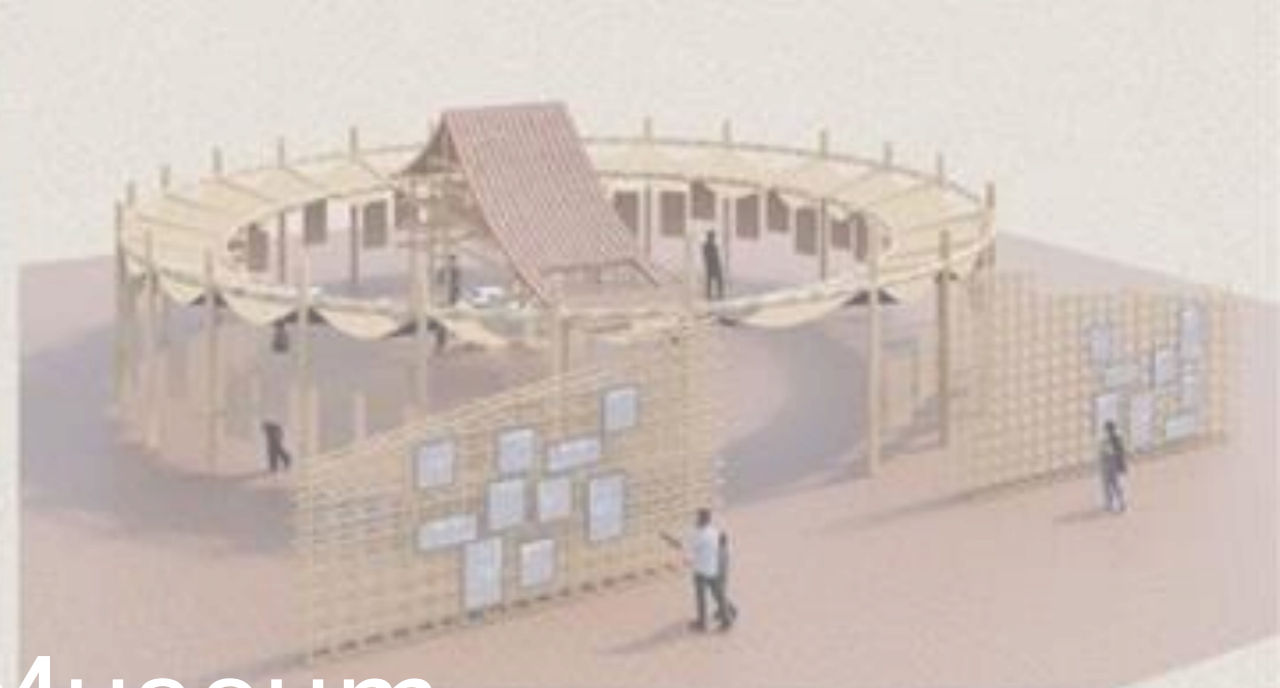

# Living Museum



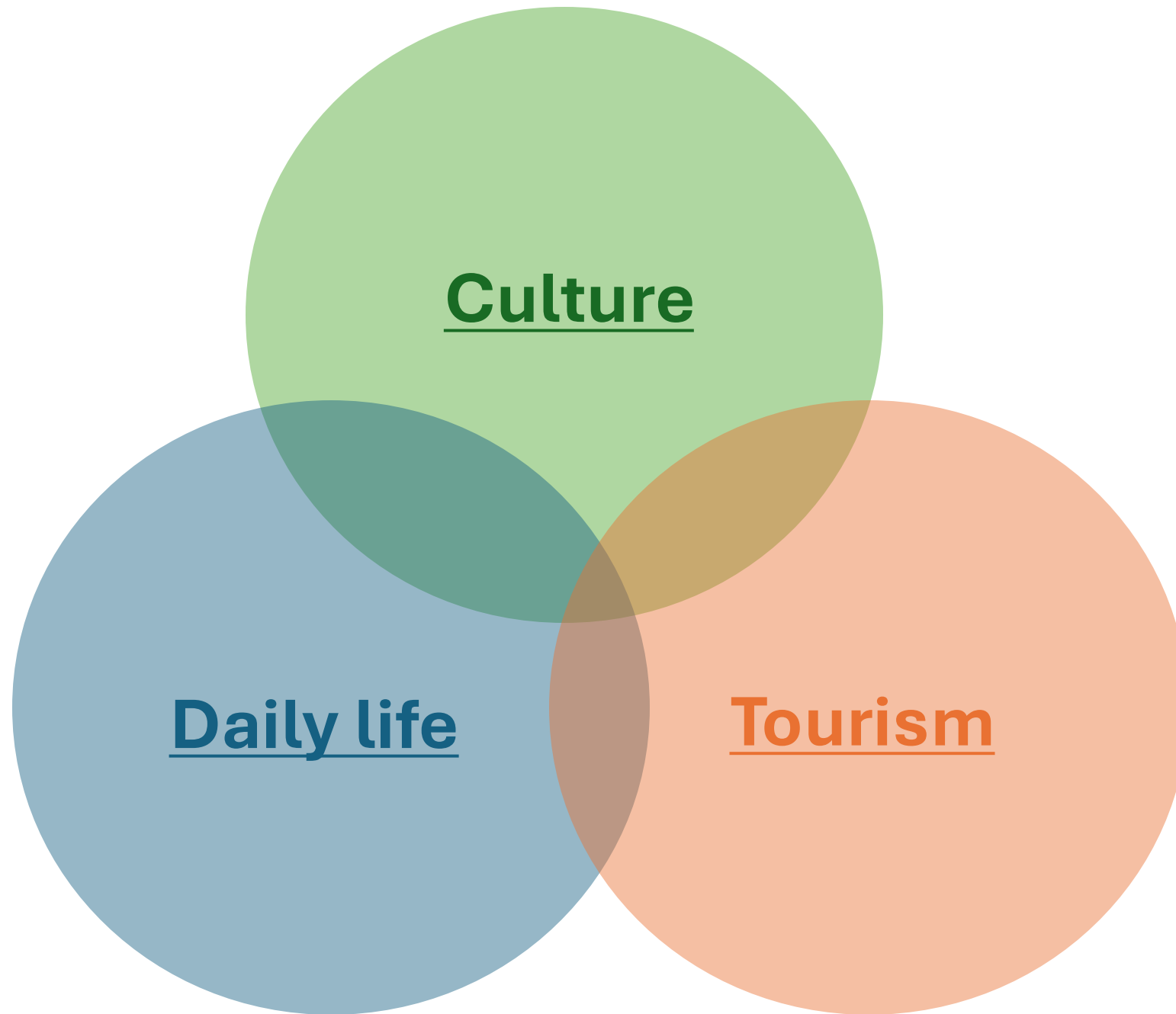



# History





# History Daily life

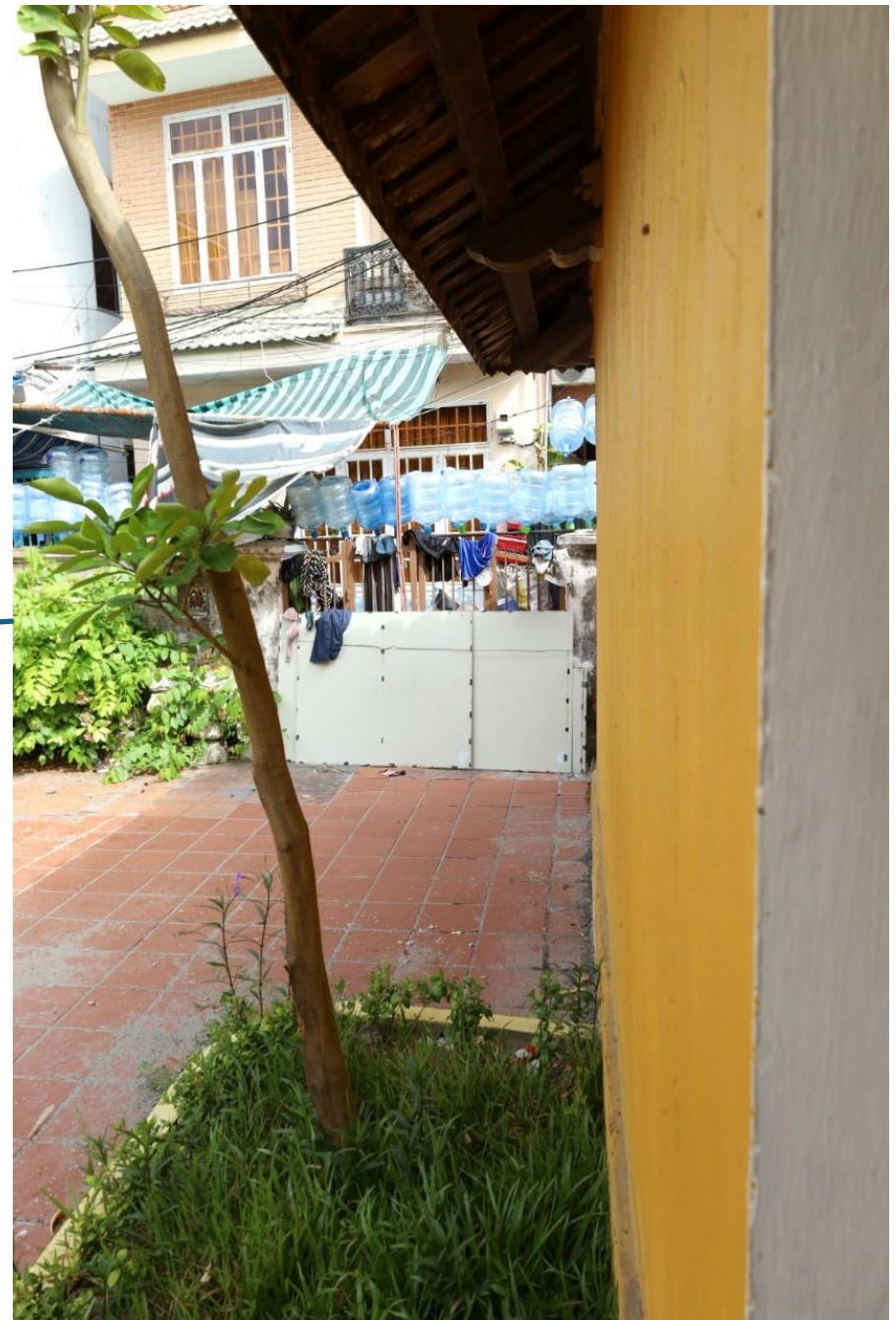



## Daily life

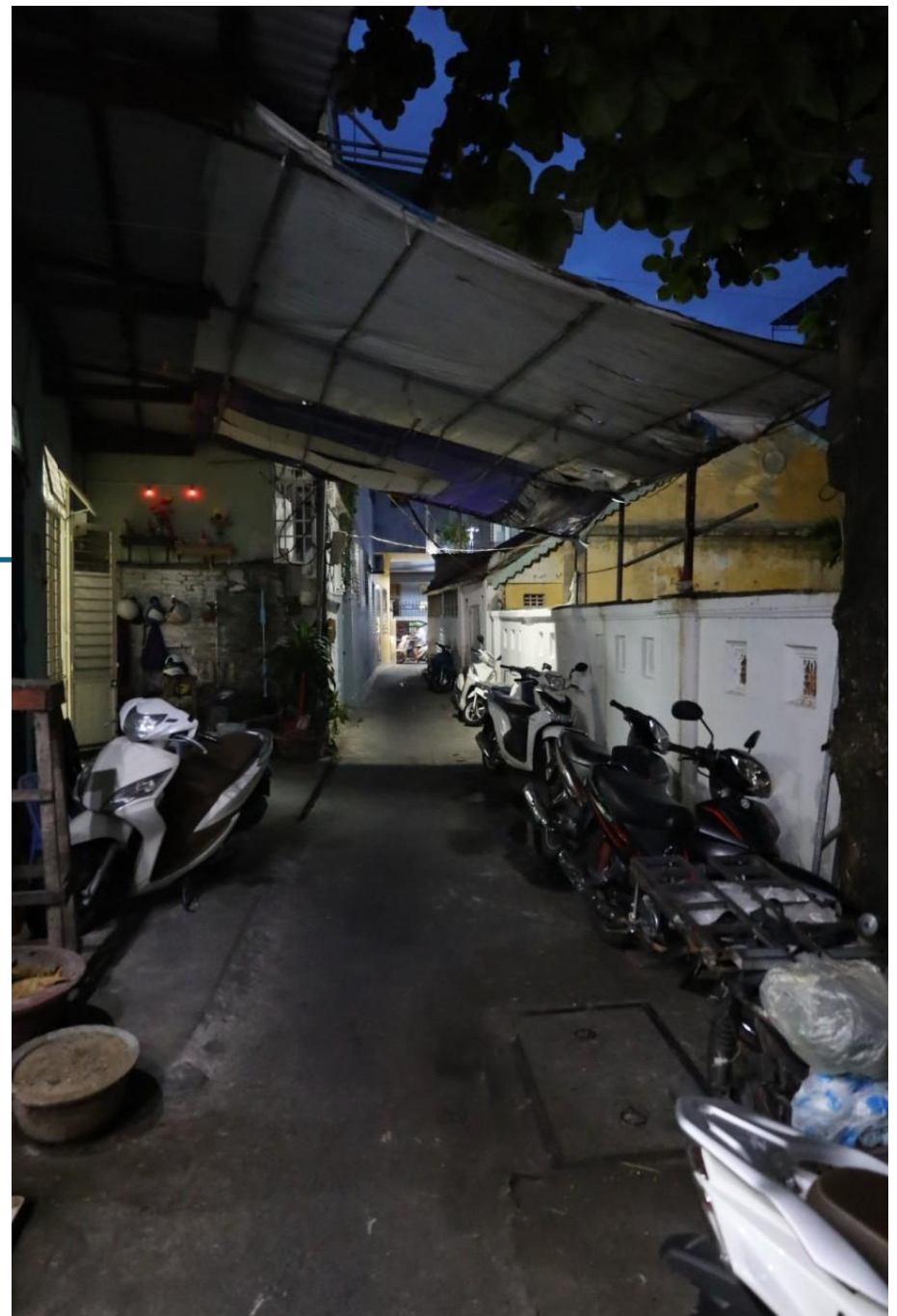



# Daily life Tourism





# Tourism



HAN market



# PROBLEMS AND SOLUTIONS

## 1. 2 SMALL ALLEY K46 Phan Chau Trinh St



## 2. PEOPLE COMMITTEE OF HAI CHAU DISTRICT It is expected to relocate and leave empty space

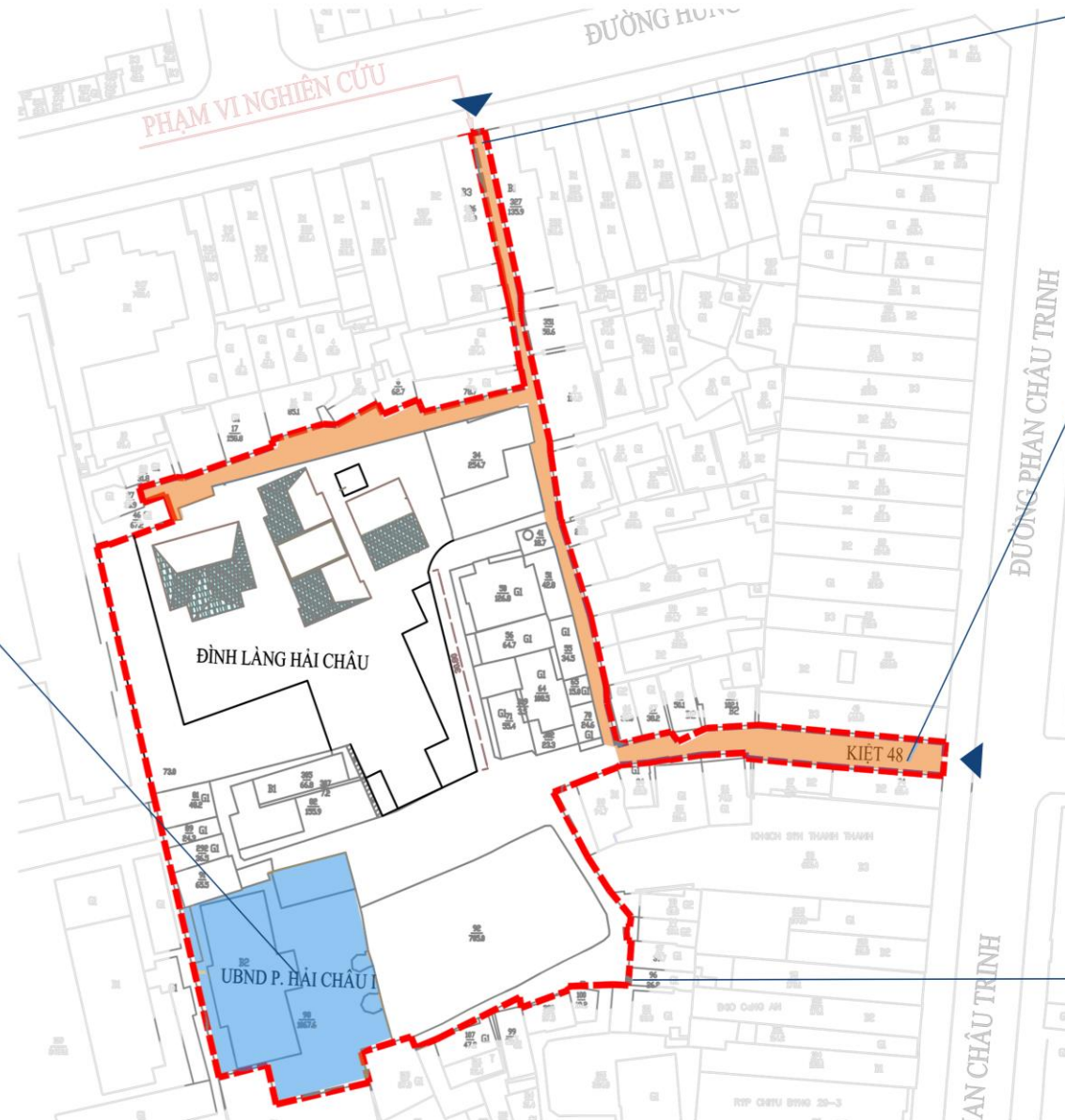

## 3. OVERALL



# 1. SMALL ROADS

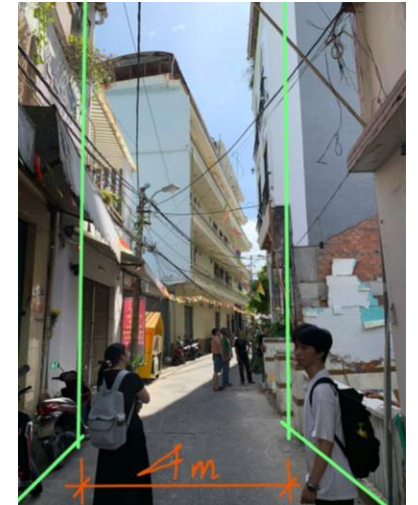
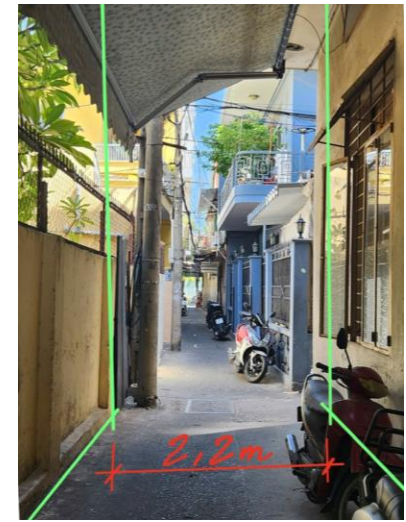

The entrance to the village communal house is from two nondescript small roads . The space inside the road is simply a walkway

- Develop spatial form for small roads
- Arrange additional decorative details for the walkway

## 2. NEW SPACE



- The People's Committee will relocate, leaving a huge empty space in the Hai Chau communal house complex

### **Solution**

- Set up open space
- Arrange the exhibition area
- Create architectural shapes to highlight





### 3. OVERALL LANDSCAPE

The space of the communal house and the surrounding area is not connected, the space is not optimized

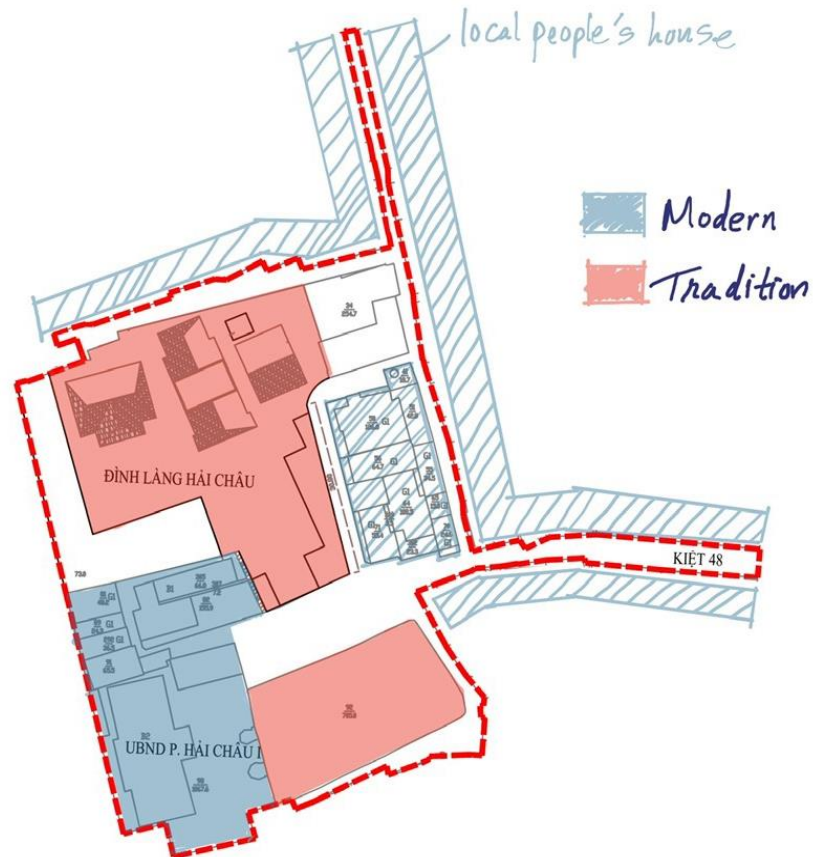

#### Solution

- Static and dynamic space zoning
- Create transition space
- Use traditional details but stylize and simplify them to fit modernity

# SMALL ROADS

K46 HOANG DIEU ST

Create a highlight for the alley with a two-story frame system, inspired by Japan

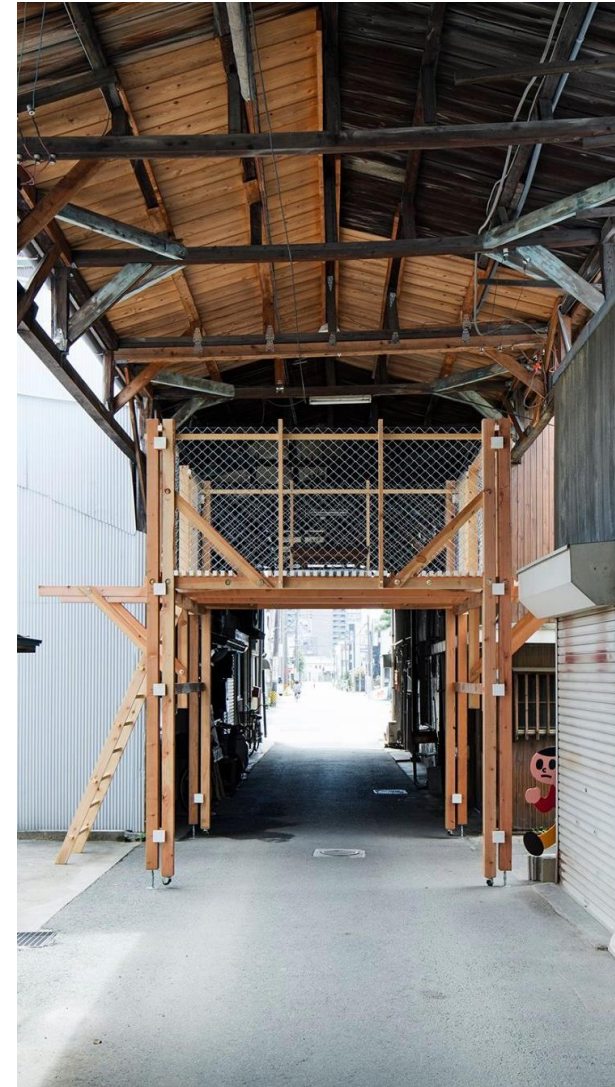
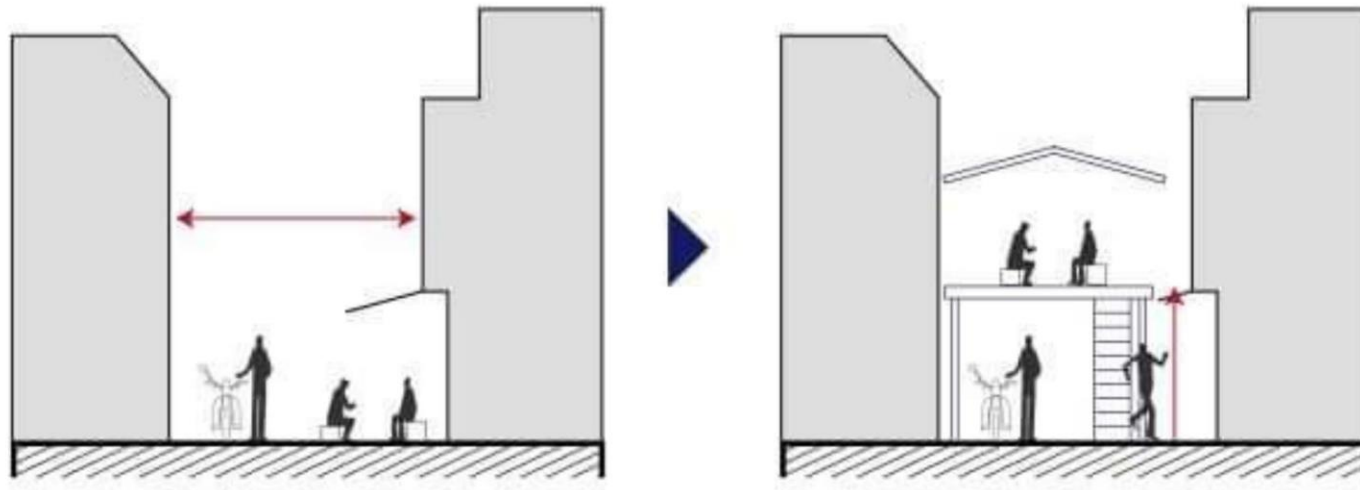
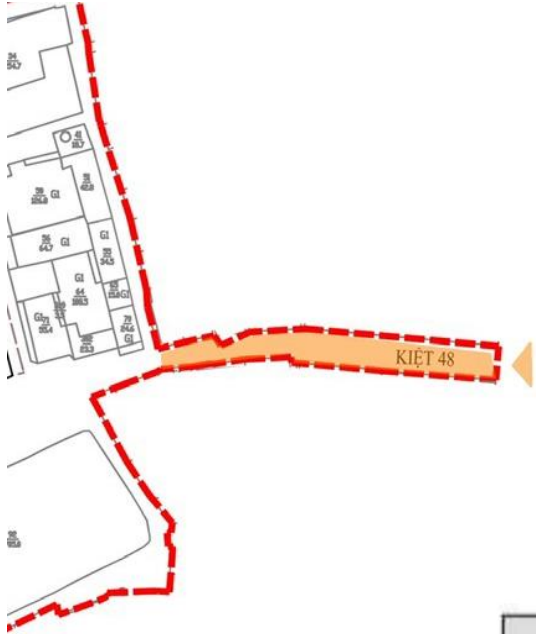

*The Tower of Matsumoto  
in Japan*



# SMALL ROADS

*K46 HOANG DIEU ST*

To avoid encroaching on the exterior space of local people's houses, this 2-storey structure system can be moved along the alley.

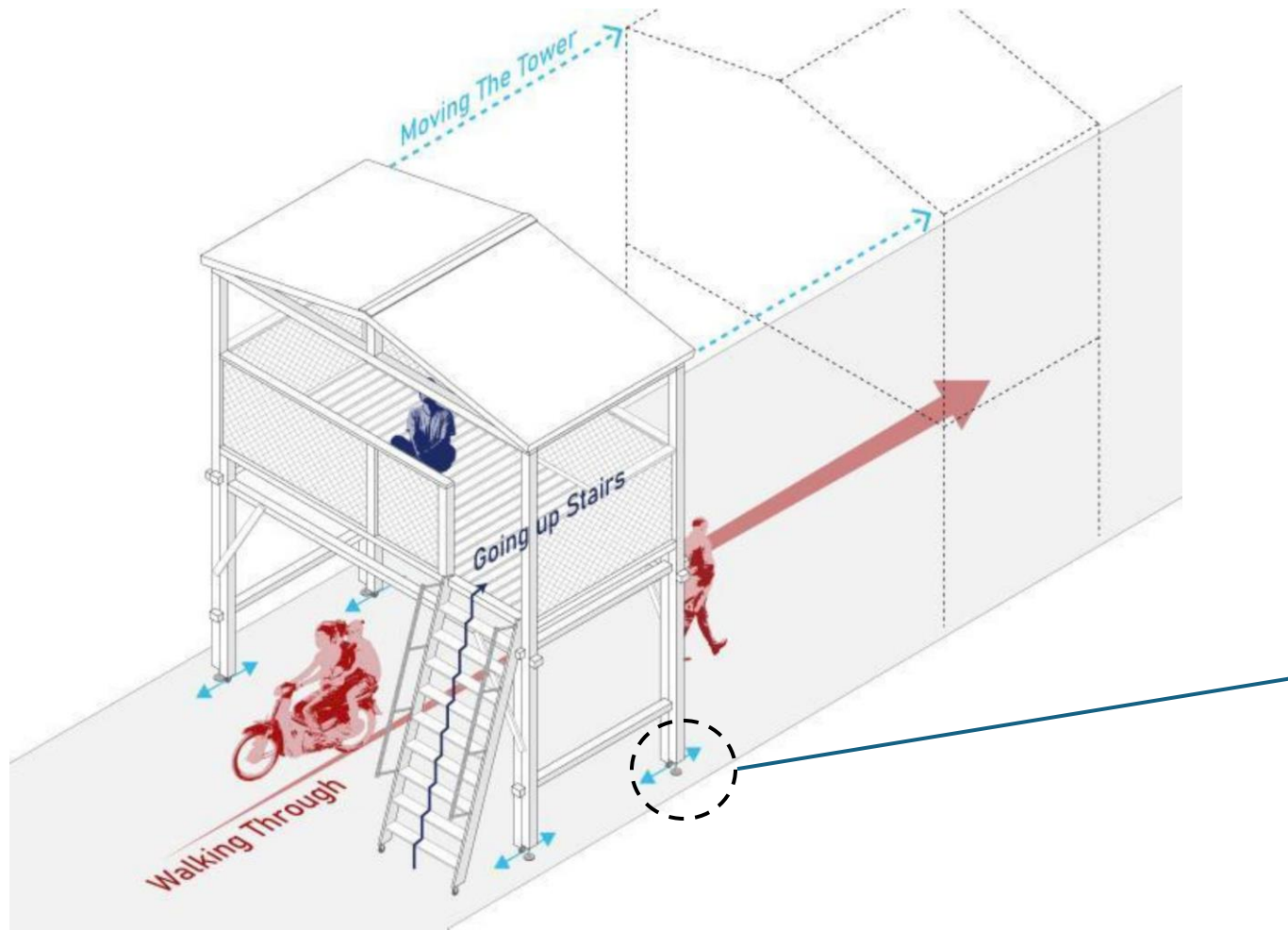

How to move roller

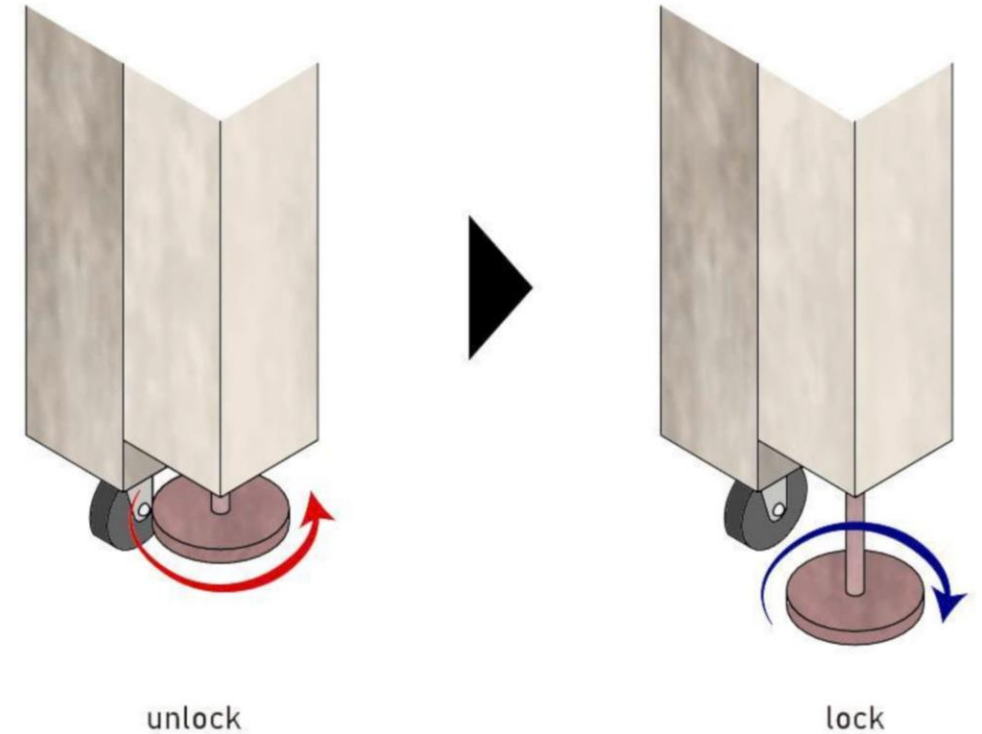

***THIS CAN BE MOVE!***

# SMALL ROADS

*K75 HUNG VUONG ST*





# SMALL ROADS

*K75 HUNG VUONG ST*

## MASTERIAL



BAMBOO



SILK



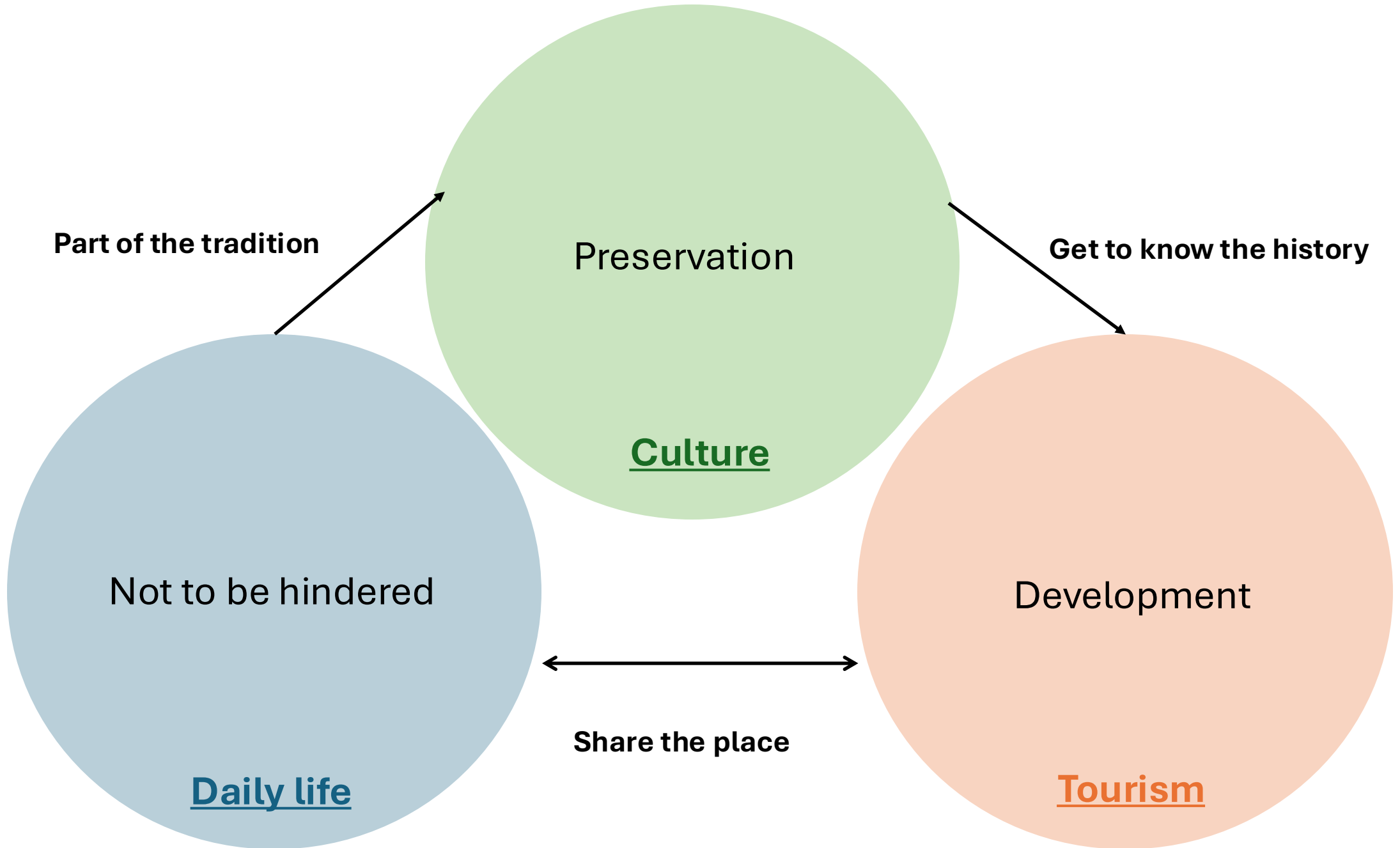







## IDEA FOR EXHIBITION SPACE



### CONNECTION

Design an open space connecting the community



### COMBINATION

Combination of traditional and modernity

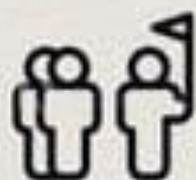

### TOURISM

Developing local tourism

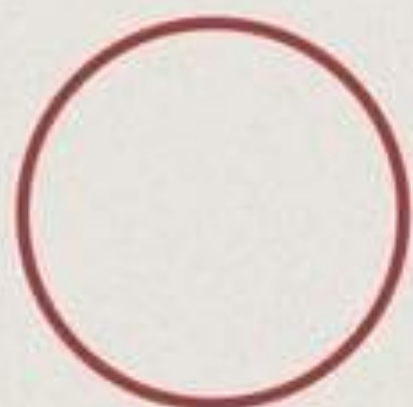

CIRCLE

The circle shows the community connection and historical intersection between modern and traditional.



CENTER

The highlight of the exhibition center is a pavilion used to display historical artifacts.

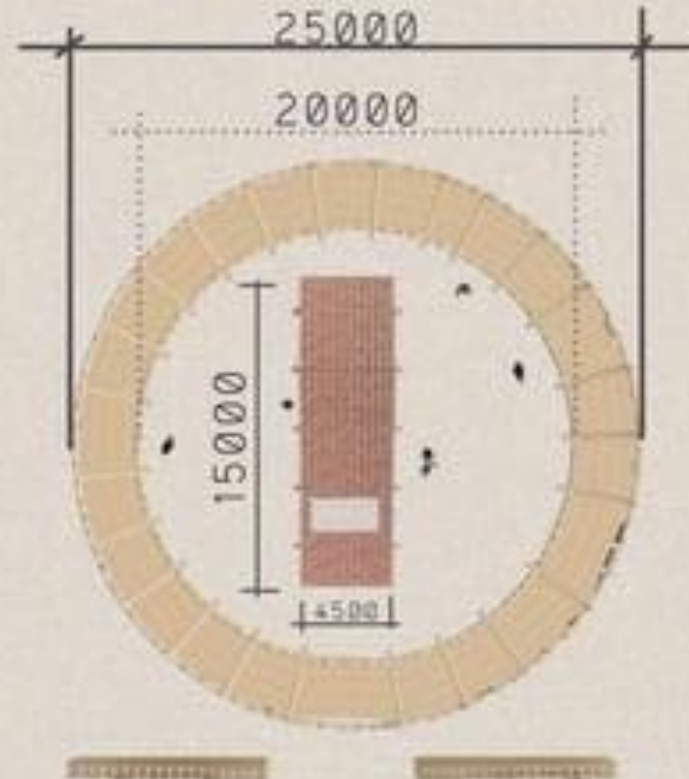



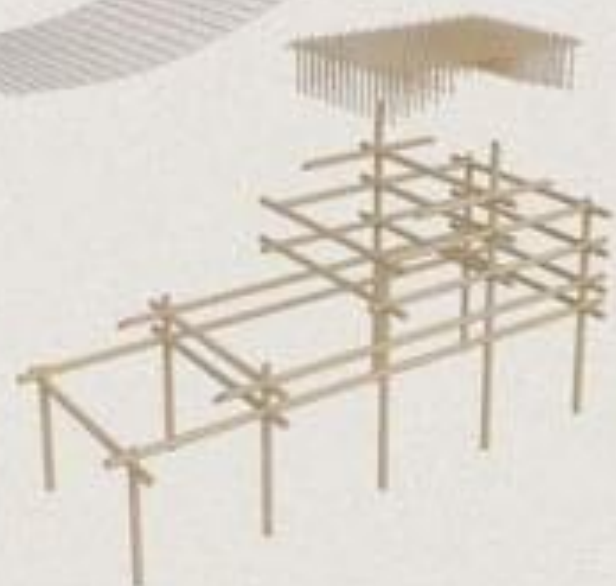

PAVILION

IDEA

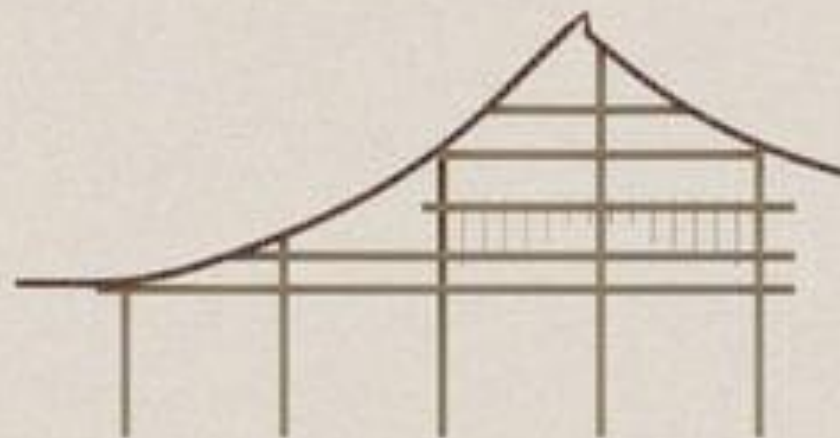
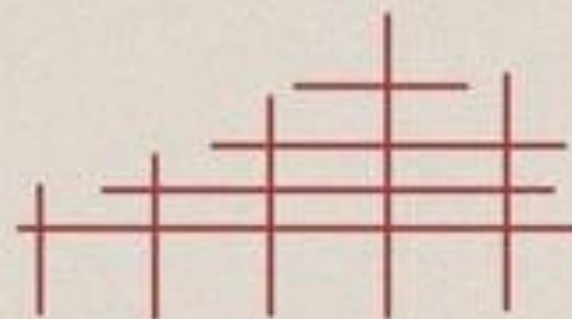
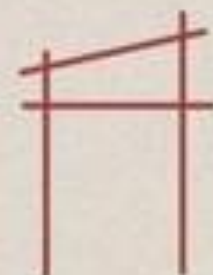
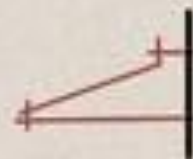
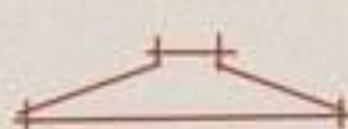

TRADITIONAL MATERIAL



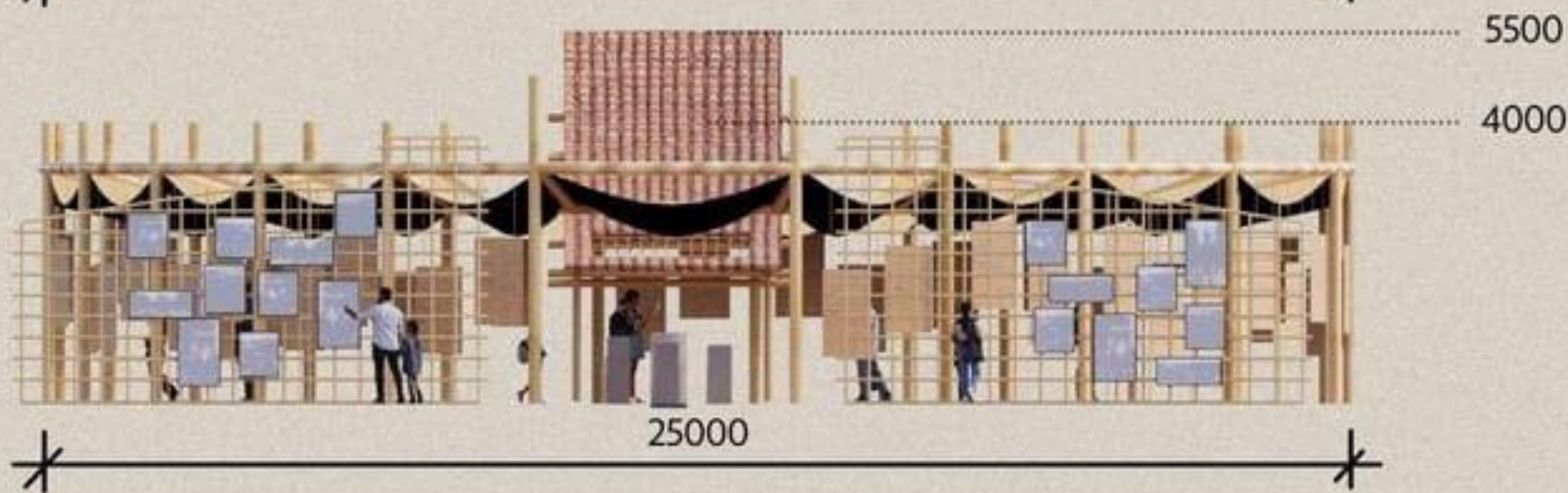
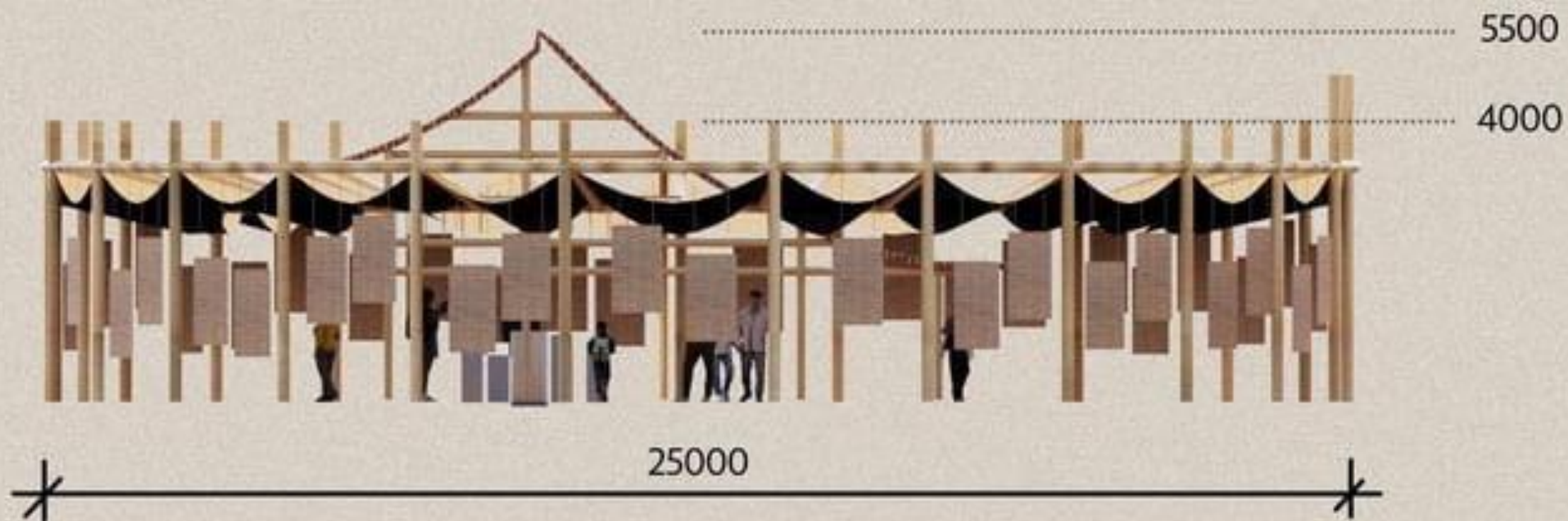



# OVERALL LANDSCAPE

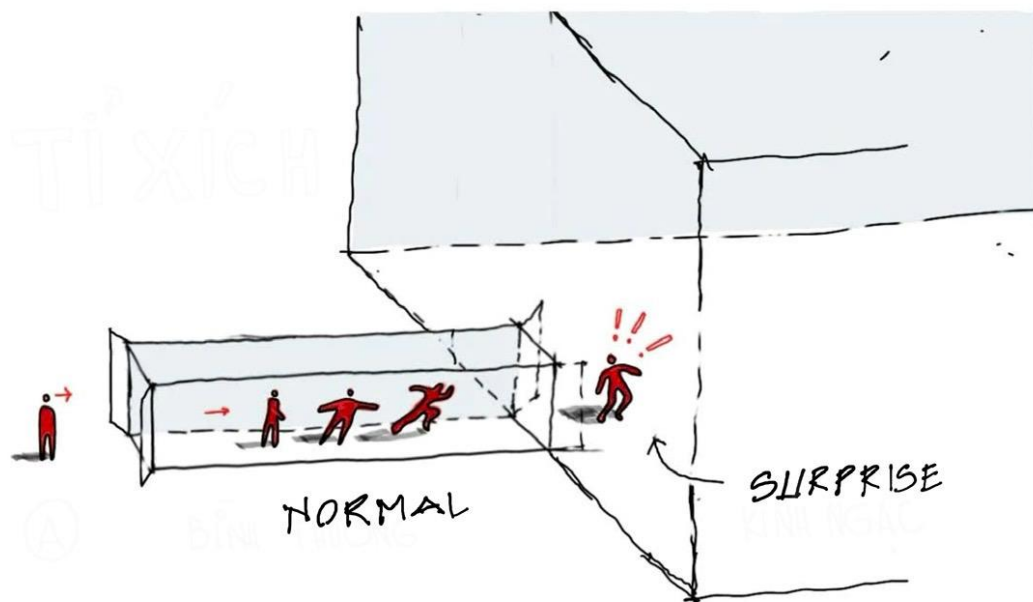

*Inspired by Chuyen ke Sketching*

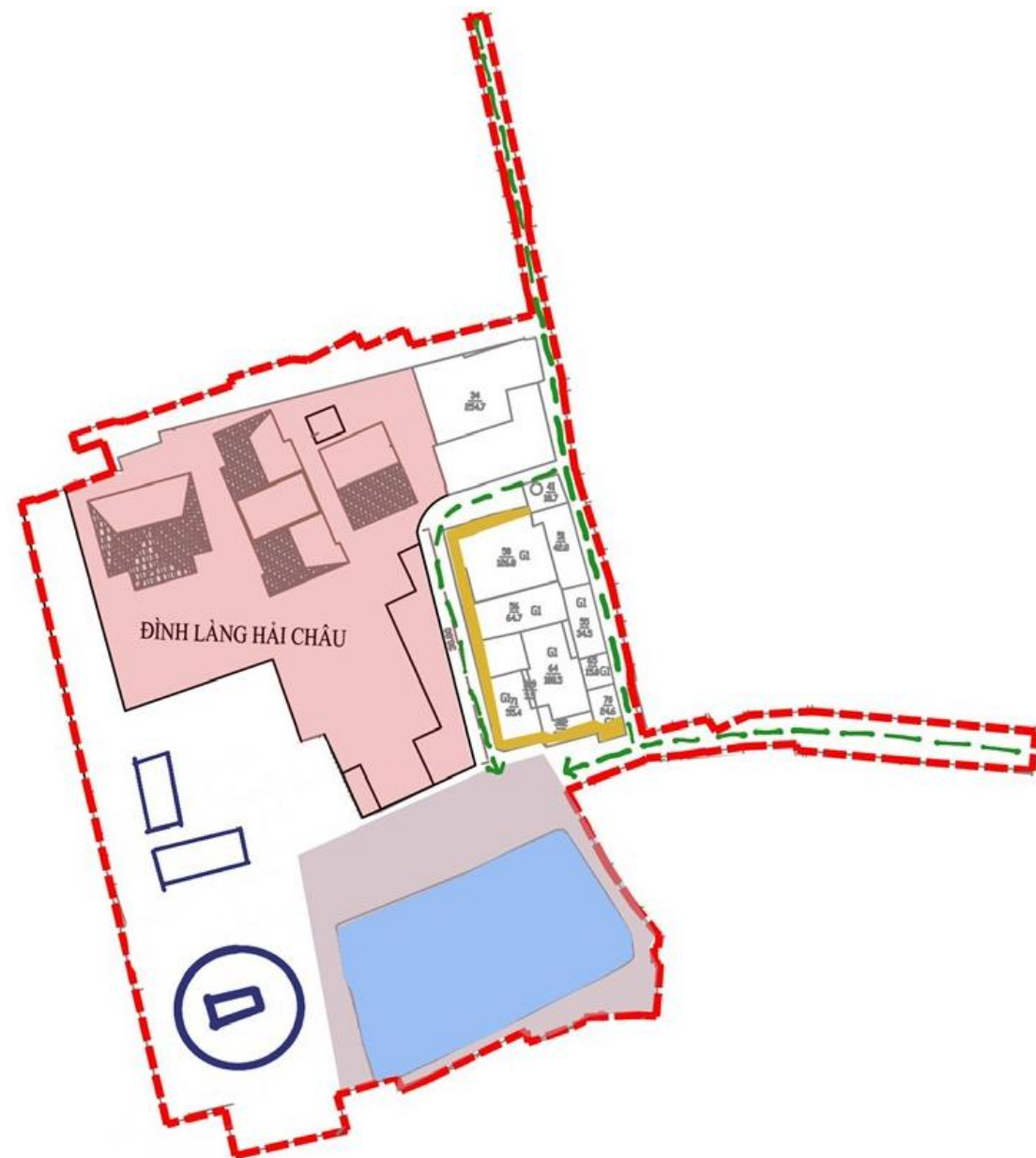







# OVERALL LANDSCAPE

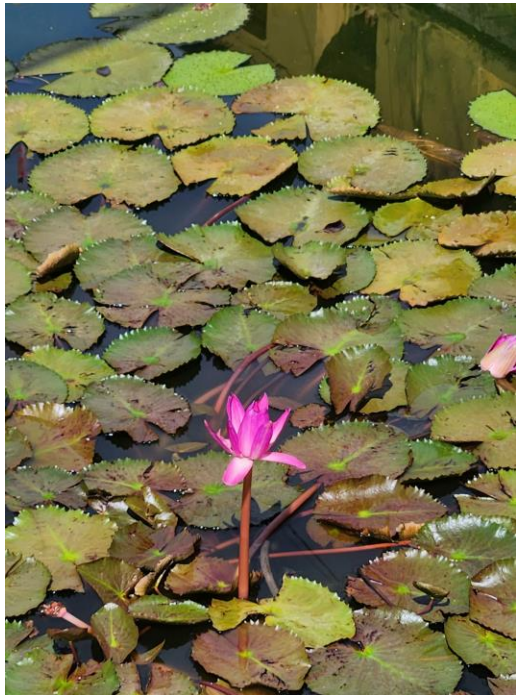

The space around the lake is peaceful and loved by local people. We will not design or change it but will keep its original beauty intact

The large lake in front of the village communal house has feng shui significance and is characteristic of traditional Vietnamese communal house architecture

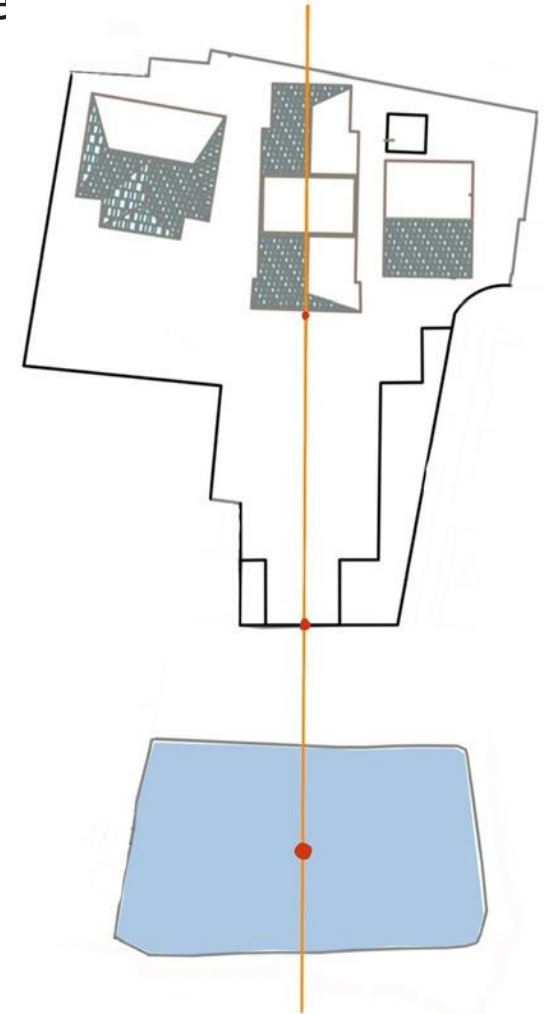

# OVERALL LANDSCAPE

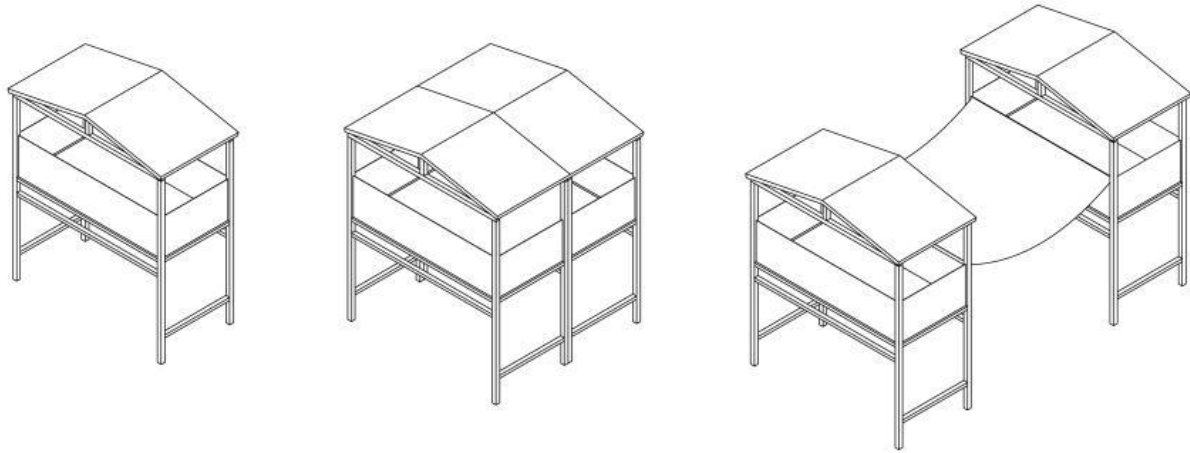

2nd Floor System  $\times 1$

2nd Floor System  $\times 2$

2nd Floor System  $\times 2$  + Tarp Roof

The 2-storey system can be put together and create a play area for children or used when there are events in the village.





